

# Model: 2201 - U

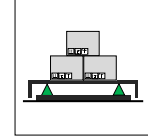

5 kg ... 500 kg



Platform Tartım

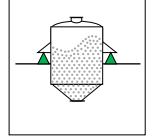

Tank Tartım

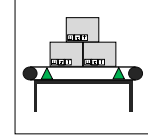

Konveyör Tartım

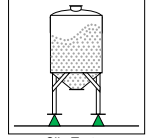

Silo Tartım

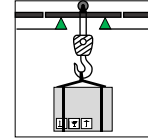

Monoray Tartı

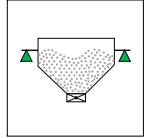

Bunker Tartım

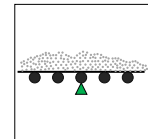

Bant Kantarı

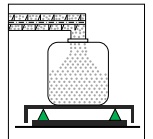

Dolum Uygulamaları

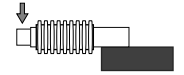

## Ölçüler (mm)

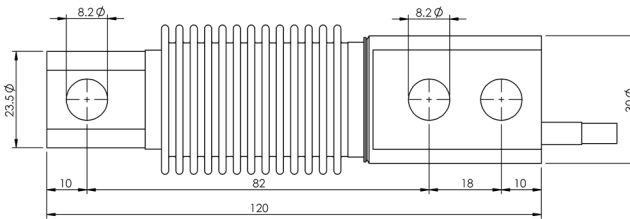
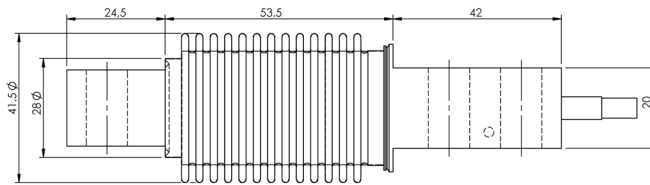
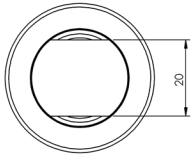

## Kullanım Şekli / Montaj Aparatı

(\*) Ayrıntılar "Montaj Aparatları" kısmında verilmiştir.

2201-M01

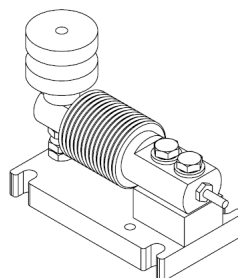

### Teknik Özellikler

|    | Parametreler                   | Değer   |                           | Birim             |
|----|--------------------------------|---|---------------------------|-------------------|
| 1  | Nominal Kapasite ( $E_{max}$ ) | 5, 10, 20, 30, 50, 75, 100, 150 200,<br>250, 300, 500 | 50, 75, 100, 150 200, 250 | kg                |
| 2  | Sinyal Kazancı                 | 2   |                           | mV/V              |
| 3  | Doğruluk Sınıfı                | C3  | C6                        |                   |
| 4  | Toplam Hata                    | $< \pm 0,017$   | $< \pm 0.008$             | %FSO              |
| 5  | Sürünme Hatası                 | $< \pm 0,016$   | $< \pm 0.008$             | %FSO              |
| 6  | Sıfır Üzerine Sıcaklık Etkisi  | $< \pm 0,01$  | $< \pm 0.005$             | %FSO / °C         |
| 7  | Çıkış Üzerine Sıcaklık Etkisi  | $< \pm 0,006$   | $< \pm 0.0003$            | %FSO / °C         |
| 8  | Sıfır Dengesi                  | $< \pm 2$   |                           | %FSO              |
| 9  | Sıcaklık Aralığı (Düzeltilmiş) | -10 ... +40   |                           | °C                |
| 10 | Sıcaklık Aralığı (Güvenli)     | -30 ... +70   |                           | °C                |
| 11 | Güvenli Aşırı Yükleme          | 150   |                           | % $E_{max}$       |
| 12 | Kırılma kapasitesi             | 200   |                           | % $E_{max}$       |
| 13 | Besleme Gerilimi (Tavsiye)     | 10  |                           | V                 |
| 14 | Besleme Gerilimi (Maks)        | 15  |                           | V                 |
| 15 | Giriş Direnci                  | 400 $\pm$ 20  |                           | $\Omega$          |
| 16 | Çıkış Direnci                  | 350 $\pm$ 3   |                           | $\Omega$          |
| 17 | Yalıtım Direnci                | > 5000  |                           | M $\Omega$ (100V) |
| 18 |                                |   |                           |                   |

(\*) FSO = Full Scale Output

### Kablo Özellikleri

